

- $d_a$  Außendurchmesser Rohrschaft (Durchschnittswert, da um ca. 3 mm/m konisch)
- $d_1$  Innendurchmesser
- $d_{so}$  Muffendurchmesser hinter Dichtung (am Beton)
- $d_{sp}$  Spitzenddurchmesser
- $l_{so}$  Muffentiefe
- $d_R$  Höhe des Dichtrings
- $d_g$  Außendurchmesser Glocke
- $t$  Wandstärke (min)

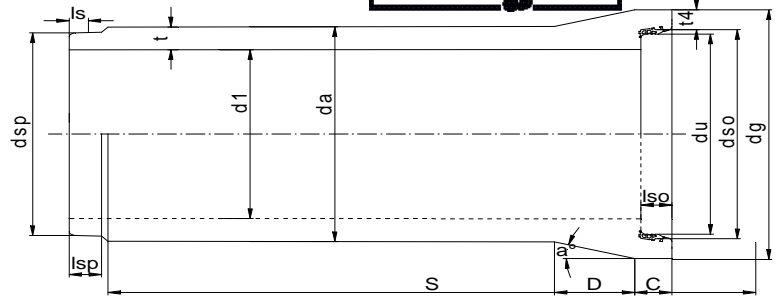

alle Längenangaben in mm

Rohr	DN $d_1$	Bau- länge	Wand- stärke t	Ø Glocke $d_g$	Ø Rohr außen min $d_{a_{min}}$	Ø Rohr außen max $d_{a_{max}}$	Ø Spitz- ende $d_{sp}$	Spitz- end- länge $l_{sp}$	Ø Muffe innen $d_{so}$	Muffen- tiefe $l_{so}$	Gewicht (to/m)	Dicht- ungstyp	Höhe Dichtung $d_R$	Rohr- typ	Last- klasse	NF 120
K-GM 300/450x3000	300	3.000	75	568	450	454	404,0	90	419,6	80	0,23	BL-R	12,0	GM	165	x
K-GM 300/450x3000 KA	300	3.000	75	568	450	454	404,0	90	419,6	80	0,23	BL-R	12,0	GM	200	x
K-FM 300/520x3000 ROBUST	300	3.000	110	548	520	548	404,0	90	419,6	80	0,38	BL-R	12,0	FM	200	x
K-GM 400/550x3000	400	3.000	75	670	550	552	505,3	95	523,5	85	0,29	BL-R	14,0	GM	165	x
K-GM 400/550x3000 KA	400	3.000	75	670	550	552	505,3	95	523,5	85	0,29	BL-R	14,0	GM	200	x
K-FM 400/620x3000 ROBUST	400	3.000	110	648	620	648	505,3	95	523,5	85	0,48	BL-R	14,0	FM	200	x
K-GM 500/656x3000	500	3.000	78	770	656	660	603,0	95	621,2	85	0,37	BL-R	14,0	GM	165	x
K-GM 500/656x3000 KA	500	3.000	78	770	656	660	603,0	95	621,2	85	0,37	BL-R	14,0	GM	200	x
K-GM 600/760x3000	600	3.000	80	873	760	764	713,0	95	731,2	85	0,44	BL-R	14,0	GM	165	x
K-GM 600/760x3000 KA	600	3.000	80	873	760	764	713,0	95	731,2	85	0,44	BL-R	14,0	GM	200	x
K-GM 700/890x2500	700	2.500	95	1034	890	893	844,0	105	867,4	100	0,63	BL-R	18,0	GM	135	
K-GM 700/890x2500 KA	700	2.500	95	1034	890	893	844,0	105	867,4	100	0,63	BL-R	18,0	GM	135	
K-GM 800/990x2500	800	2.500	95	1128	990	990	962,0	105	985,4	100	0,71	BL-R	18,0	GM	135	x
K-GM 900/1120x2500	900	2.500	110	1320	1120	1120	1080,0	105	1103,4	100	0,93	BL-R	18,0	GM	135	
K-GM 1000/1240x2500	1000	2.500	120	1410	1240	1240	1198,0	105	1221,4	100	1,12	BL-R	18,0	GM	135	x
K-GM 1100/1360x2500	1100	2.500	130	1600	1360	1360	1321,0	130	1343,0	130	1,38	GS	20,0	GM	135	
K-GM 1200/1478x2500	1200	2.500	139	1730	1478	1478	1438,3	125	1460,3	125	1,60	GS	20,0	GM	135	x

Gelenkstücke

K-GM 300/450x1000 SM	300	1.000	75	516	450	454	404,0	90	419,6	80	0,22	BL-R	12,0	GM	165	x
K-GM 300/450x1000 SS	300	1.000	75	-	450	454	404,0	90	419,6	80	0,20	BL-R	12,0	GM	165	x
K-GM 400/550x1000 SM	400	1.000	75	645	550	553	505,3	90	523,5	85	0,30	BL-R	14,0	GM	165	x
K-GM 400/550x1000 SS	400	1.000	75	-	550	553	505,3	90	523,5	85	0,25	BL-R	14,0	GM	165	x
K-GM 500/656x1000 SM	500	1.000	78	742	656	660	602,8	90	621,0	85	0,38	BL-R	14,0	GM	165	x
K-GM 500/656x1000 SS	500	1.000	78	-	656	660	602,8	90	621,0	85	0,31	BL-R	14,0	GM	165	x
K-GM 600/760x1000 SM	600	1.000	80	873	760	763	713,0	105	731,2	85	0,48	BL-R	14,0	GM	165	x
K-GM 600/760x1000 SS	600	1.000	80	-	760	763	713,0	105	731,2	85	0,39	BL-R	14,0	GM	165	x
K-GM 700/890x1250 SM	700	1.250	95	1034	890	890	844,0	85	867,4	100	0,70	BL-R	18,0	GM	135	
K-GM 700/890x1250 SS	700	1.250	95	-	890	890	844,0	85	867,4	100	0,63	BL-R	18,0	GM	135	
K-GM 300/450x1000 SM KA	300	1.000	75	516	450	454	404,0	90	419,6	80	0,22	BL-R	12,0	GM	165	x
K-GM 300/450x1000 SS KA	300	1.000	75	-	450	454	404,0	90	419,6	80	0,20	BL-R	12,0	GM	165	x
K-GM 400/550x1000 SM KA	400	1.000	75	645	550	553	505,3	90	523,5	85	0,30	BL-R	14,0	GM	165	x
K-GM 400/550x1000 SS KA	400	1.000	75	-	550	553	505,3	90	523,5	85	0,25	BL-R	14,0	GM	165	x
K-GM 500/656x1000 SM KA	500	1.000	78	742	656	660	602,8	90	621,0	85	0,38	BL-R	14,0	GM	165	x
K-GM 500/656x1000 SS KA	500	1.000	78	-	656	660	602,8	90	621,0	85	0,31	BL-R	14,0	GM	165	x
K-GM 600/760x1000 SM KA	600	1.000	80	873	760	763	713,0	105	731,2	85	0,48	BL-R	14,0	GM	165	x
K-GM 600/760x1000 SS KA	600	1.000	80	-	760	763	713,0	105	731,2	85	0,39	BL-R	14,0	GM	165	x
K-GM 700/890x1250 SM KA	700	1.250	95	1034	890	890	844,0	105	867,4	100	0,70	BL-R	18,0	GM	135	
K-GM 700/890x1250 SS KA	700	1.250	95	1034	890	890	844,0	105	867,4	100	0,63	BL-R	18,0	GM	135	
K-GM 800/990x1250 SM	800	1.250	95	1128	990	990	962,0	105	985,4	100	0,88	BL-R	18,0	GM	135	x
K-GM 800/990x1250 SS	800	1.250	95	-	990	990	962,0	105	985,4	100	0,74	BL-R	18,0	GM	135	x
K-GM 900/1120x1250 SM	900	1.250	110	1320	1120	1120	1080,0	105	1103,4	100	1,28	BL-R	18,0	GM	135	
K-GM 900/1120x1250 SS	900	1.250	110	-	1120	1120	1080,0	105	1103,4	100	1,01	BL-R	18,0	GM	135	
K-GM 1000/1240x1250 SM	1000	1.250	120	1410	1240	1240	1198,0	130	1221,4	100	1,35	BL-R	18,0	GM	135	x
K-GM 1000/1240x1250 SS	1000	1.250	120	-	1240	1240	1198,0	130	1221,4	100	1,15	BL-R	18,0	GM	135	x
K-GM 1100/1360x1250 SM	1100	1.250	130	1600	1360	1360	1321,0	125	1343,0	130	1,65	GS	20,0	GM	135	
K-GM 1100/1360x1250 SS	1100	1.250	130	-	1360	1360	1321,0	125	1343,0	130	1,25	GS	20,0	GM	135	
K-GM 1200/1478x1250 SM	1200	1.250	139	1730	1478	1478	1438,3	125	1460,3	125	1,90	GS	20,0	GM	135	x
K-GM 1200/1478x1250 SS	1200	1.250	139	-	1478	1478	1438,3	125	1460,3	125	1,40	GS	20,0	GM	135	x